

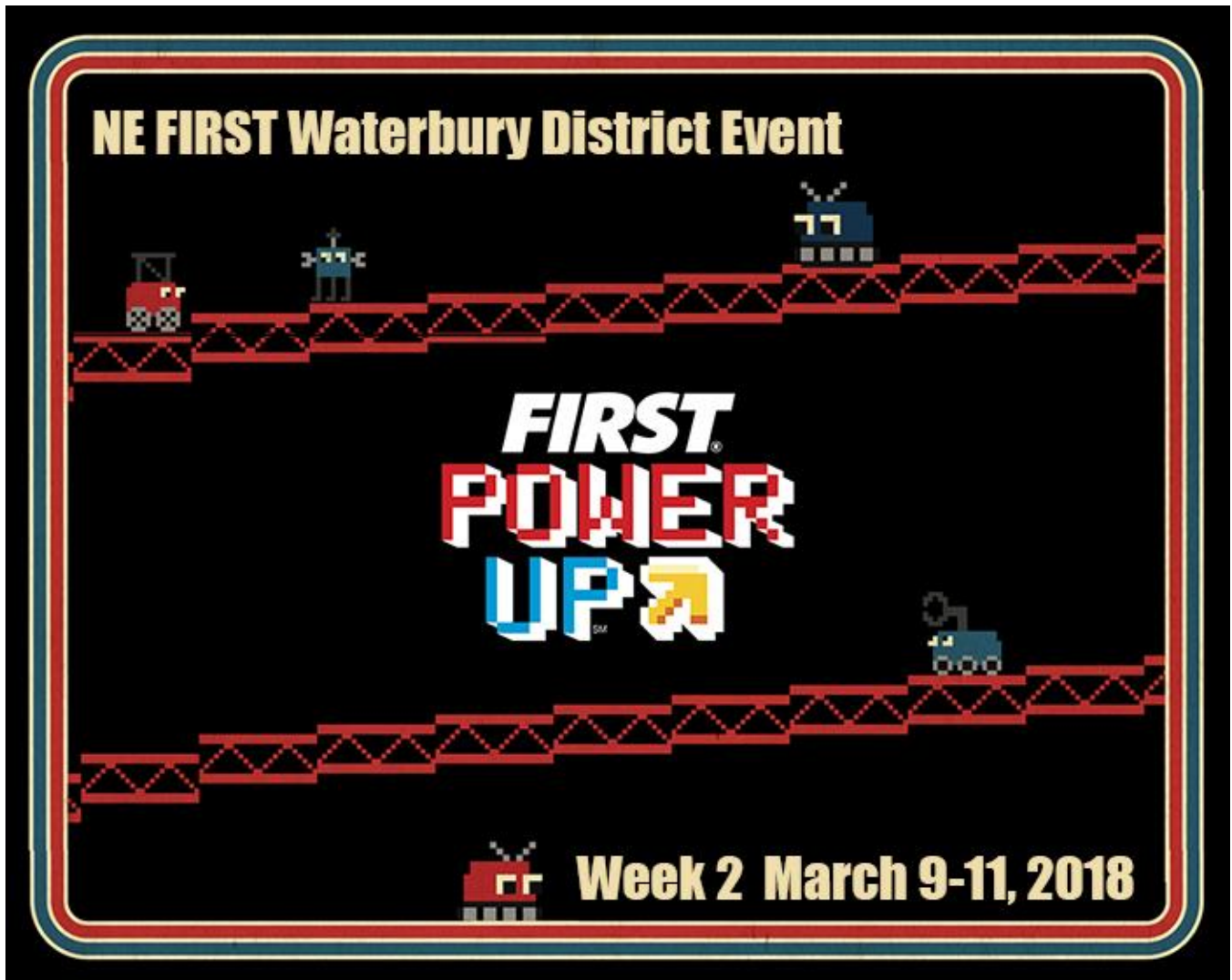

Team Information Packet



Welcome Teams!

On behalf of the 2018 *NE FIRST* Waterbury District Planning Committee, I would like to welcome you to our event! This is an exciting time for the *FIRST*® Waterbury District Competition as we continue to grow and adapt.

This year, we're thrilled to host 34 teams from Connecticut, Massachusetts, New Hampshire and New Jersey at Wilby High School on March 9-11, 2018 to compete in "*FIRST*® POWER UPSM."

Our planning committee has been hard at work for many months to prepare a weekend of high-quality, fun-filled, intense team experiences that embody the *FIRST* Core Values of Gracious Professionalism® and Coopertition®! We hope you meet new friends, achieve your team goals, and have great time while at our event!

*As Dean Kamen writes, "FIRST is **More Than Robots**. FIRST participation is proven to encourage students to pursue education and careers in STEM-related fields, inspire them to become leaders and innovators, and enhance their 21st century work-life skills."*

In this packet, you will find a great deal of information specific to the Waterbury event. Please read through this information carefully and share it with your team.

We look forward to seeing you in Waterbury on March 9!

Sincerely,

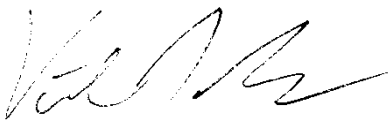
A handwritten signature in black ink, appearing to read "Vincent J. Balsamo".

Vincent J. Balsamo
NE FIRST Waterbury Planning Committee Chair

***NE FIRST* District**
Waterbury Event Planning Committee

Vincent J. Balsamo
Carol Scully
David Givens
David Goric
Linda Horn
Kathie Kentfield
Bill Reis

1 General Instructions for Teams

This document includes **LOAD-IN and Parking maps**, plus special instructions and rules that are specific to the 2018 Waterbury District Event. Please make sure that ALL mentors and team members see, hear, and/or read these instructions.

All final event decisions are made by NE FIRST, with Carol Scully, Regional Director, as point of contact.

2 Visitors and Community Outreach

We love visitors at our events! But we also want them to be safe!

- ⚡ All event attendees must wear closed-toe and closed-back shoes as well as safety glasses when visiting the pits. All long hair should be tied back.
- ⚡ Safety glasses are limited in supply so if you have extra glasses, bring them for your visitors.
- ⚡ Children under age 12 must be accompanied by an adult at all times!
- ⚡ Inform visitors that “robots have the right of way” in our pits – and to be aware of their surroundings.
- ⚡ Explain FIRST’s credos of Gracious Professionalism® and Coopertition® to your visitors.

If you know of people interested in starting a team in any of our four FIRST programs, please send their name and contact information to Carol Scully, Regional Director, cscully@nefirst.org, so that we can connect with them and arrange for tours at the event and schedule our mandatory training sessions this spring. Let us know if you are interested in mentoring a team.

3 Venue

The 2018 Waterbury District Event will be held at:

Wilby High School
460 Bucks Hill Road
Waterbury, CT 06704

3.1 Directions to the Venue

Waterbury, CT is accessible by Interstate 84 and CT-8. Wilby High School is located off Exit 36 on CT-Route 8. **Please plan ahead for traffic on Interstate 84 on Friday afternoon and evening.**

From 84 East:

Take Exit 20 (left exit) to CT-Route 8 North. Follow directions for CT-Route 8 North.

From 84 West:

Take Exit 20 to CT-Route 8 North. Follow directions for CT-Route 8 North.

From Route 8 North:

Take Exit 36; turn right on Huntingdon Ave (Huntingdon Ave. becomes Homer St.). At the 4th light turn left on Cooke Street. At end of Cooke Street turn right onto Boyden Street. At end of Boyden Street turn left on Bucks Hill Road. Wilby is 3/4 Mile on the right. (See Figure 1 next page)

From Route 8 South:

Take Exit 36; at end of ramp turn left on Colonial Ave. Take first left on Huntingdon Ave. (Huntingdon Ave. becomes Homer St.). At the 4th light turn left on Cooke Street. At end of Cooke Street turn right onto Boyden Street. At end of Boyden Street turn left on Bucks Hill Road. Wilby is 3/4 Mile on the right. (See Figure 1 next page)

Please note Boyden Street involves a very steep grade hill. In the case of inclement weather, please use this alternate route: Continue on Huntingdon Ave. (becomes Homer St./Chase Ave.) for 1.5 miles. Take a sharp left onto North Main St. In 1 mile take slight left onto Bucks Hill Rd. Wilby HS is 1 mile on the right. (See Figure 2 next page)

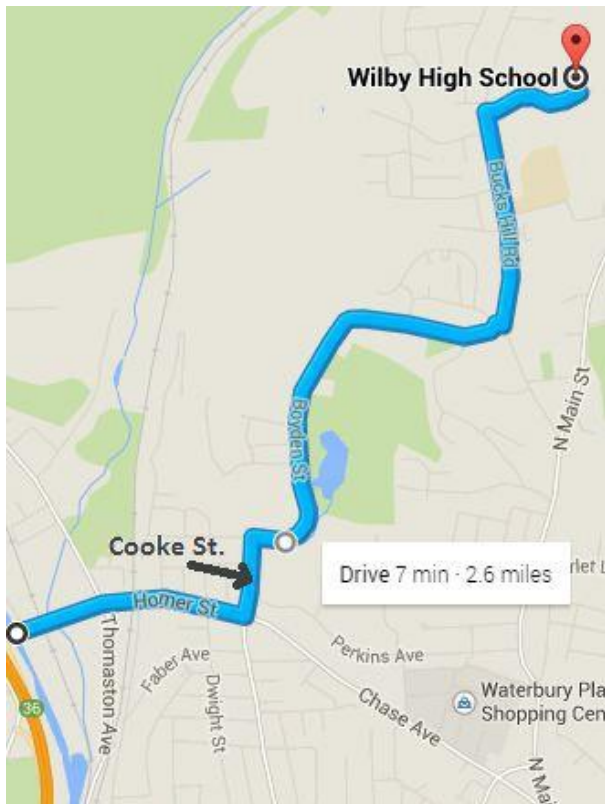

Figure 1: Normal Route

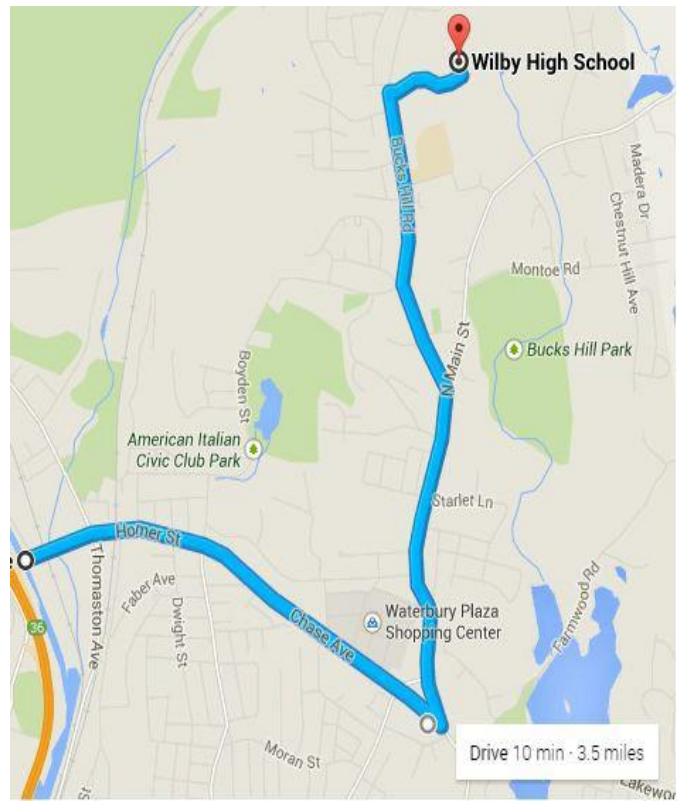

Figure 2: Inclement Weather Route

3.2 Parking Map

Please note change from previous years:



Figure 3: Parking Lots

A “park and drive at your own risk” is in effect at all times. The City of Waterbury cannot give unconditional guarantee of security and is not responsible for personal injury, damage, or theft of vehicles or belongings.

3.2 Team Load-In

Teams will go to the Wilby High School entrance off of Bucks Hill Road (do not enter through the Middle School entrance.) Follow the red arrows on the map to the circle to unload. Continue around the circle for parking:

3.3 Car Parking

Teams traveling by car may park in the area marked Car Parking on the map. This space is also designated for spectator parking.

3.4 Bus Unloading/Parking

Enter through the Wilby High School Parking Entrance (Lot #1) and unload students in the front circle of the school. Busses should exit by looping around bus circle to Bucks Hill Road or use the bus parking area (last driveway on the right before Bucks Hill Road).

3.5 Trailer Unloading/Parking (New)

Teams with trailers will go to the Wilby High School entrance off of Bucks Hill Road (do not enter through the Middle School entrance.) Follow the red arrows on the map to the circle to unload. When done, continue around circle back to Bucks Hill Road. Turn left onto Bucks Hill Road. Take your second left into the driveway behind the schools. Park in the Trailer lot designated on the map, above.

4 Load-In and Load-Out

On Day 0 the event committee will be working to set up all areas of the event. Along with this, it is possible we will have some work to complete in the pits while teams are arriving. Therefore we are asking ahead of time for your consideration and patience. **Although entire teams are allowed to attend Day 0 per the rules, you may wish to only bring essential personnel to the Friday check in and inspection.** Teams will not be allowed in areas still undergoing setup unless directed by event personnel. **Day 0 Load-in is required.** If you have a hardship please contact Carol Scully, cscully@nefirst.org, prior to the event.

4.1 Bag and Tag Rules

- ⚡ You must bring your own bagged, tagged, and sealed robot into the venue through the designated robot entrance.
- ⚡ Teams will NOT have access to a loading dock or forklift; we recommend bringing a rolling cart or dolly to facilitate the load-in.
- ⚡ Bags may not be opened until they have been checked, approved by an on-site inspector, and the pits have officially been opened for robot work. Teams may load in at 5 p.m. on Day 0.
- ⚡ **Please be sure to bring an additional tag for resealing your robot after the event so it can be properly transferred to another competition.**

4.2 Load-In - Day 0 (Friday)

- ⚡ **Teams are expected to bring their robot on Day 0 to check in and begin inspection.** While we hope to offer practice matches as early as possible on Day 0, there is no guarantee that teams will be afforded practice time.
- ⚡ Starting at 5 p.m. on Day 0, teams may begin unloading their robots and pit equipment. You may enter without wearing safety glasses, but please use caution. Unpacking and donning safety glasses should be a priority.
- ⚡ Robot drop-off traffic:
 - ⚡ Use the Wilby High School Entrance off Bucks Hill Rd. Robot drop-off will occur in the front circle of the school.
 - ⚡ Team vehicles must queue in the driveway and will be directed to the unloading area by event staff.
 - ⚡ **During load-in, vehicles may NOT be left unattended in the drop-off circle. The robot drop-off circle is a fire lane and must be able to be cleared.**
 - ⚡ Exit by looping around bus circle and follow parking directions, above.

4.3 Load-Out - Day 2 (Sunday)

- ⚡ After alliance selection, the top 8 robots that were not picked will remain as backup robots. (see <https://firstfrc.blob.core.windows.net/frc2018/Manual/Sections/10-Tournaments.pdf> sections 10.5.1 and 10.5.2)

- ⚡ Other teams may start loading out immediately.
- ⚡ Team vehicles must queue in the driveway and will be directed to the unloading area by event staff.
- ⚡ **During load-out, vehicles may NOT be left unattended. The driveway is a fire lane and must be able to be cleared.**
- ⚡ In the spirit of Gracious Professionalism®, teams are expected to remain in attendance through elimination matches and the final awards ceremony.

4.4 Tips

- ⚡ Please plan ahead for traffic on Interstate 84 approaching Waterbury, especially on Friday afternoon and evening.
- ⚡ Prepare for bad weather. We encourage teams to prepare a team-based system for coordinating emergency information, including changes to the event schedule due to weather. Changes to the event schedule, etc. will be communicated via text message. Anyone may sign up to receive text messages about the NE FIRST Waterbury District Event by texting the keyword **powerupwaterbury** to 84483.
- ⚡ Transport team materials in closed container.

5 Venue Rules

See *FIRST* General Rules: <http://www.firstinspires.org/resource-library/frc/event-experience>

PLEASE DO:

- ⚡ Distribute team pins and similar promotional items for teams and spectators.
- ⚡ Bring enough safety glasses for your team and visitors.
- ⚡ Wear safety glasses at all times in the PIT and on/around the playing field. During the event you will not be allowed into the pit without safety glasses, even to retrieve safety glasses. Be sure all team members have their safety glasses with them when entering the venue! Our safety glasses are for loan to our visitors and not to our teams. This will be strictly enforced.
- ⚡ Hang your team banners on the wall behind the bleachers using non-marking tape. Be FRIENDLY and use Gracious Professionalism with other teams and spectators while sharing the stands.
- ⚡ Be sure that your team mascots can see clearly and have an escort at all times if wearing a costume, and that they respect the personal space and boundaries of spectators.

PLEASE DON'T:

- ⚡ Attempt to deliver or ship robots, pit setups, tools, and/or materials directly to the site. Everything must be carried in during load in.
- ⚡ Sell any products such as food, hats, shirts, or any promotional products.
- ⚡ Open any peanut-based food products in the venue. **Wilby HS is a peanut-free school.**
- ⚡ Distribute out any free food products, such as candy, water, soft drinks, fruit.
- ⚡ Use noisy devices, such as floor stompers, whistles, and/or air horns.
- ⚡ Invite or bring live bands to play in the audience.
- ⚡ Play loud music in the Pit because it interferes with important announcements.
- ⚡ Arrange for Internet access on the site.
- ⚡ Use walkie-talkies as they interfere with the wireless radios used by event service providers as well as the district event volunteers.
- ⚡ Wear open-toed or open-backed shoes in the Pits or on the playing field. This includes “clog” and “mule” style shoes, such as Crocs. New this year: Rule E02-2. All team members must tie back long hair.
- ⚡ Store bulky items such as coolers, coats, backpacks in the bleachers (see item 5.1 below.)

If event staff deems something or someone to be unsafe or against Waterbury or *FIRST* standards, they will work with the person(s) to correct the situation. If the situation cannot be corrected, the item will be removed or the person(s) will be asked to leave. Finally, please respect the event staff as we are attempting to run a smooth event and keep everyone safe.

5.1 Seating in the Arena

Ample bleacher style seating is available for teams with great views of the competition field. Please do not try and save seats as it is not permitted per [Rule E03](#). Teams are encouraged to share seats with each other and accommodate for spectators. Please do not sit in the front row of the bleachers – this area is reserved for persons with special needs.

For safety reasons we ask teams to not store backpacks, coats, coolers and other bulky items in the bleachers. Teams may reserve a Team Homeroom for this purpose for Day 1 and 2. Team Main and Alternate Contacts have been sent an email with details on how to reserve a room. Teams that have reserved a room will receive their Team Homeroom assignment, procedures, and hours for accessing the room in their Team Registration Packet on Day 0.

5.2 Media Pass

Waterbury DE teams will receive one Media Pass Button upon check-in. The button grants access to one person from your team to take photos or videos from a special designated seating area field-side at this event only. Your media person will be allowed access to that seating ONLY during your team's matches. The FTA and/or Head Referee may rule that there are too many people field-side at any time, or abuse of the pass has been made, and revocation of this benefit is at their discretion.

5.3 Machine Shop Information/Rules

General Rules and Process for machine shop work requests:

- ⚡ Any onsite work will be done by certified operators.
- ⚡ You must supply any material that is needed for repairs. The machine shop cannot provide scrap material.
- ⚡ One team representative must initially accompany their request to the shop request table, but may leave after providing any needed explanations.

6 Emergencies

IN CASE OF EMERGENCY:

Notify personnel at the Pit Admin table or the Scorekeeping table of the emergency. They will notify the emergency responders on duty at the event as well as the Event Coordinator.

We encourage teams to identify a meeting place away from the building (i.e. the team bus) where team members will meet if a building evacuation is necessary.

7 Building Layout

The "Layout" schematic in the Appendix shows the location of all rooms to be used during the competition. Please share this with your team.

8 The Pits

- ⚡ A proposed pit map is included in the Appendix. It is subject to change. Teams will receive a final pit map when they register at the Pit Administration table on Day 0.
- ⚡ Each team's pit will have a 6ft table and 1 power outlet and is approximately 9' X 9' so plan accordingly.
- ⚡ Due to safety and regulations, teams cannot build any structure that supports people or items for storage above the work area in their pit space.
- ⚡ No structures should be higher than 10 feet above the floor and must safely support any signs or displays mounted to the structure.
- ⚡ As a special reminder, don't forget:
 - ⚡ A 25ft heavy duty extension cord and a power strip.
 - ⚡ A small cart to transport your heavy robot from the Pit to the playing field.
 - ⚡ Safety glasses for everyone on your team and your guests that will be visiting the pits.
- ⚡ Review the *FIRST* Suggested Items to Bring list:
https://www.firstinspires.org/sites/default/files/uploads/resource_library/frc/game-and-season-info/competition-manual/2017/suggested-items-to-bring-to-events.pdf

9 Event Schedule

The general public schedule is in the Appendix and is subject to change without notice. All times are estimated based on the flow of rounds.

Match schedules will be released as soon as possible on Day 1. We recommend you post your match schedule in your pit for team members and visitors. Please see Pit Administration for updated match times throughout the event.

10 Consent and Release Forms

We strongly encourage all team members and mentors submit their Consent and Release forms electronically. Mentors registered in TIMS may complete the electronic Consent and Release form in TIMS, and student team members/parents may complete their Consent and Release forms electronically via the *FIRST* Youth Team Member Registration (STIMS).

Note that all team members must complete the *FIRST* form as well as print out and complete a District form which can be found here: <https://nefirst.org/wp-content/uploads/2016/10/2017-New-England-consent-and-release-Form.pdf> . The **NE *FIRST* form for each team member must be brought to Pit Admin at the first *FIRST* event you attend along with your team roster.**

11 Inclement Weather

In the event of inclement weather please check your email and the event's Facebook (<https://www.facebook.com/events/1909667662693571/>) and Twitter (@NE_Waterbury) for updates. We suggest you create a plan for notifying team members in case of a change of schedule. You may also sign up to receive text alerts by texting the keyword **powerupwaterbury** to 84483.

12 The Competitors

A team list appears in the Appendix. Thirty-four teams from Connecticut, Massachusetts, New Hampshire and New Jersey will be competing at our event!

13 Chairman's Award Presentations

Eligible teams that submitted for the Chairman's Award will need to sign up at pit admin and provide a Chairman's Award Video Consent Form in order to be interviewed by the Judges at the event. If a team does not sign up for an interview slot, they will be considered ineligible to earn the Chairman's Award at that event. Be sure to come prepared with your Chairman's Video, Video Consent Form and Judge Feedback Form if you wish to receive feedback. To receive feedback, teams submitting for Chairman's Award must fill out their Team Number and Team Name on the Chairman's Award [feedback form](#) and provide it to the Judges at the beginning of their Chairman's Award interview. **To ensure that ALL teams get their feedback forms back, please ALSO include a stamped self-addressed envelope with the feedback form.** For additional information visit the *FIRST* website: <http://www.firstinspires.org/resource-library/frc/submitted-awards>

14 Photos

Immediately following the conclusion of the awards ceremony on Sunday evening the playing field will be available for 20 minutes for the Chairman's Award and Winning Alliance teams to pose for photos. Please plan accordingly.

15 Additional Activities at the Venue

Plan to visit the various tables and booths set-up in the entrance lobby. *FIRST* will have a table with information about the four *FIRST* programs in case you are interested in starting a team, or know someone who wants to! Be sure to visit the Welcome table for information about *FIRST* scholarships.

A Mentor Lounge (Room 206) will be open on Day 1 and 2 with coffee, tea, water and light refreshments. This is a quiet space for mentors to make phone calls, take a break or network with other mentors.

A Competition Advancement Meeting will be held on Day 2 at 10 a.m. in the Mentor Lounge. Regional Director Carol Scully will discuss details about advancing to District Championships in Boston. Each team should send one mentor.

16 Food

Concessions will be available for teams and guests throughout our event. In addition, teams may pre-order a lunch package and leave the work to us! Details are in the Appendix. (Teams may also bring food into the venue from outside, but coolers, etc. must be stored in your Team Homeroom until lunchtime.) Tables are limited so be considerate of your fellow *FIRST*ers who may be waiting for a table. **Wilby HS is a peanut-free school.**

17 *FIRST* Tiara/Silly Hat/Favorite Hat Day

It is a *FIRST* tradition for the Championships Volunteers to wear a tiara or silly hat or favorite hat one day at Champs. We are continuing the tradition at our District Event on Day 1, Saturday. We encourage teams to join our Volunteers and wear their favorite tiara/silly hat/favorite hat!

18 Social Media – Make it Loud!

🌐 Facebook: <https://www.facebook.com/events/1909667662693571/>

🌐 Twitter: @NE_Waterbury

Hashtags: #NEwat #WeAreNE #omrobots #MakeThingsBetter

19 Website

<https://nefirst.org/event/ne-district-waterbury-district-event/>

20 Resources

Competition Manuals: <http://www.firstinspires.org/resource-library/frc/competition-manual-ga-system>

FIRST POWER UP one-page game description: available in the Appendix – print a copy for your visitors!

21 Contacts

Got any last-minute questions? Email Kathie Kentfield, Team Liaison at kentfieldk@gmail.com.

Are you running late? Call and let us know your status!

- ☎ Carol Scully, Event Coordinator: 860.989.1688
- ☎ Kathie Kentfield, Team Liaison: 860.416.9148

APPENDIX

FOOD

Concessions and Pre-Ordered Lunches provided by:

J. F. Kennedy High School FRC Team 3525, The Nuts & Bolts of Fury

Bagged lunches are to be picked up in the Middle School Café, 11 a.m. to 11:45 a.m.

All other concession food is available in the Middle School Café.

The Concession Committee would like to thank all the volunteers who will make this weekend a success!



For more information contact:

Denise Work, parent concession coordinator

denise@bitworksusa.net

203.206.5442



2018 Waterbury District Event
Waterbury, Connecticut
March 9-11, 2018

TEAM PRE-ORDERED MEALS

The full food menu is attached in the appendix. Please print this out and provide it to your team to browse. We are offering teams the opportunity to pre-order Friday night dinner, Saturday lunch or dinner, and Sunday lunch.

Teams can pre-order whole large pizzas for Friday night; they are \$15 for cheese, \$17 for pepperoni or veggie. Pizza orders need to be emailed to Denise Work (Denise@Bitworksusa.net) by 5 p.m. on Friday, March 2, 2018.

Teams can pre-order a variety sandwiches and chips along with water for Saturday lunch and dinner and Sunday lunch. These orders will need to be emailed to Denise Work (Denise@Bitworksusa.net) by Wednesday, March 7, 2018.

The menu is as follows:

Ham Sandwich (w/ Cheese, Lettuce and Tomato)	\$5.00
Turkey Sandwich (w/ Cheese, Lettuce and Tomato)	\$5.00
Case of chips (variety pack)	\$15.00
Case of Water	\$10.00

Please make checks payable to: The Nuts and Bolts of Fury Inc.



Concession Menu

Breakfast: 8 a.m. - 10:30 a.m. Saturday & Sunday
Lunch: 11 a.m. - 3:30 p.m. Saturday & Sunday
Team Bagged Lunch Pickup: 11 a.m.- 11:45 a.m.
Dinner: 5 p.m. - 6:30 p.m. Saturday only
Snacks & Such: 8 a.m. - 6:30 p.m.

Breakfast

Egg Sandwich w/cheese	\$4.00
Egg Sandwich w/Canadian bacon	\$5.50
Egg Sandwich w/sausage	\$5.50
Bagel w/cream cheese or butter	\$2.00
Donut	\$1.00
Apples or Bananas	\$1.00

Beverages

Water	\$1.00
Soda	\$1.00
Gatorade	\$1.00
Coffee	\$1.00
Tea	\$1.00
Orange Juice	\$1.00

Lunch/Dinner

Hot Dog	\$2.00
Cheese Burger	\$5.00
Grilled Cheese	\$3.00
Fries	\$2.00
Garden Salad	\$4.00
Garden Salad w/chicken	\$6.00
Pizza Slice (cheese)	\$2.00
Chili w/cheese	\$3.00
Macaroni & Cheese	\$3.00
Ham Sandwich	\$6.00
Turkey Sandwich	\$6.00
Baked Potato w/cheese	\$3.00
Add Chili	\$1.00

Snacks & Such

Chips	\$0.50
<i>Dippy's</i> Ice Cream Sandwiches	\$1.50
Candy	\$1.00
Popcorn	\$2.00
Cookies (2)	\$1.00
Pretzel	\$2.00
Nacho's w/cheese	\$2.00

2018 DISTRICT SCHEDULE

Day 0 – Friday, March 9, 2018

5:00 p.m. – 10:00 p.m. Pits Open for Load-In; Robots are Inspected

Day 1 – Saturday, March 10, 2018

8:00 a.m.	Pits Open; Practice Rounds; Remaining Inspections
10:30 a.m.	Opening Ceremonies
11:00 a.m.	Qualification Matches Begin
1:00 p.m. – 2:00 p.m.	Lunch
2:00 p.m. – 7:00 p.m.	Qualification Matches
*8:00 p.m.	Pits Close

Day 2 – Sunday, March 11, 2018

8:00 a.m.	Pits Open
9:00 a.m.	Opening Ceremonies
9:30 a.m.	Qualification Matches Begin
12:30 p.m. - 1:00 p.m.	Alliance Selections
1:00 p.m. – 2:00 p.m.	Lunch
2:00 p.m. – 5:00 p.m.	Final Rounds
5:00 p.m. – 6:30 p.m.	Awards Ceremony
*7:00 p.m.	Pits Close

**Schedule subject to change. All times are estimated based on flow of rounds.*

See Pit Administration table for updated times.

TEAM LIST

Team#	Team Nickname	City	ST
176	Aces High	Windsor Locks	CT
177	Bobcat Robotics	South Windsor	CT
181	Birds Of Prey	Hartford	CT
228	GUS Robotics	Meriden	CT
230	Gaelhawks	Shelton	CT
236	Techno-Ticks	Old Lyme	CT
237	Black Magic Robotics	Watertown	CT
501	The PowerKnights	Manchester	NH
558	Elm City Robo Squad	New Haven	CT
571	Team Paragon	Windsor	CT
999	MechaRAMS	Cheshire	CT
1085	Aquatic Robotics	Avon	CT
1099	DiscoTechs	Brookfield	CT
1124	UberBots	Avon	CT
1676	The Pascack PI-oneers	Montvale	NJ
1699	Robocats	Colchester	CT
2067	Apple Pi	Guilford	CT
2170	Titanium Tomahawks	Glastonbury	CT
3104	The Cyber Rams	Stamford	CT
3182	Athena's Warriors	West Hartford	CT
3314	Mechanical Mustangs	Clifton	NJ
3461	Operation PEACCE Robotics	Bristol	CT
3464	Sim-City	Simsbury	CT
3525	The Nuts & Bolts of Fury	Waterbury	CT
4055	NRG	Winchester	CT
4097	Devilbots	Northampton	MA
4557	FullMetal Falcons	Middletown	CT
4572	BArlow RobAutics	Redding	CT
5129	Digital Devils	Plainville	CT
5142	Robo Dominators	Hamden	CT
5856	Bullbots	Waterbury	CT
6723	Team redbot Mt Greylock Regional High School	Williamstown	MA
7266	NBHS Robotics Club	North Brookfield	MA
7269	ISB VoltBots	Cambridge	MA

LAYOUT

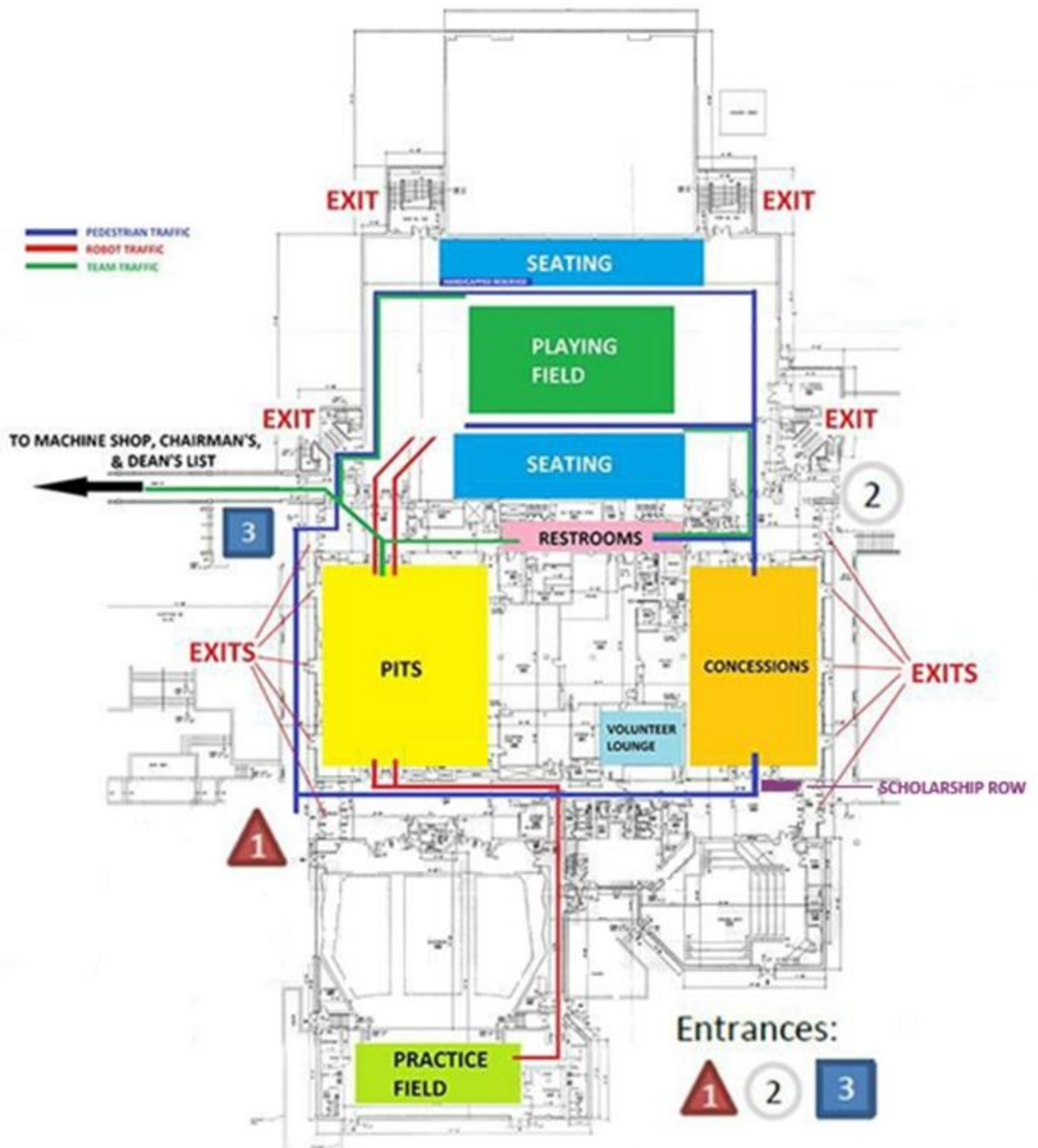

MAIN LEVEL										LOWER LEVEL														
Room 222	Room 221	Room 220	Room 219	Room 218	Room 217	Room 216	Room 215	Room 214	Room 213	Room 212	Room 211	Room 210	Room 209	Room 208	Room 207	Room 206	Stairs to Lower Level	Room 113	Room 112	Room 111 Machine Shop	Room 109	Room 108	Stairs to Main Level	
School Exit							Stairs																	
Stairs	Room 240	Room 239	Restroom	Room 238	Room 237	Room 236	Room 235																	
Stairs																								
Main Entrance to Wilby High School																								
Main Entry																								

Restrooms

Dean's List Interviews

Chairman's Presentations

Safety Advisors

Committee - Storage

Mentor's Lounge

Machine Shop Downstairs in Room 111

Media Center - Judges Room

Hallway To Main School Entrance

Bridge

To

Playing Field and Pits

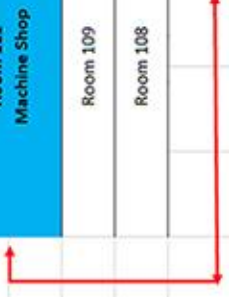

PIT MAP (subject to change)

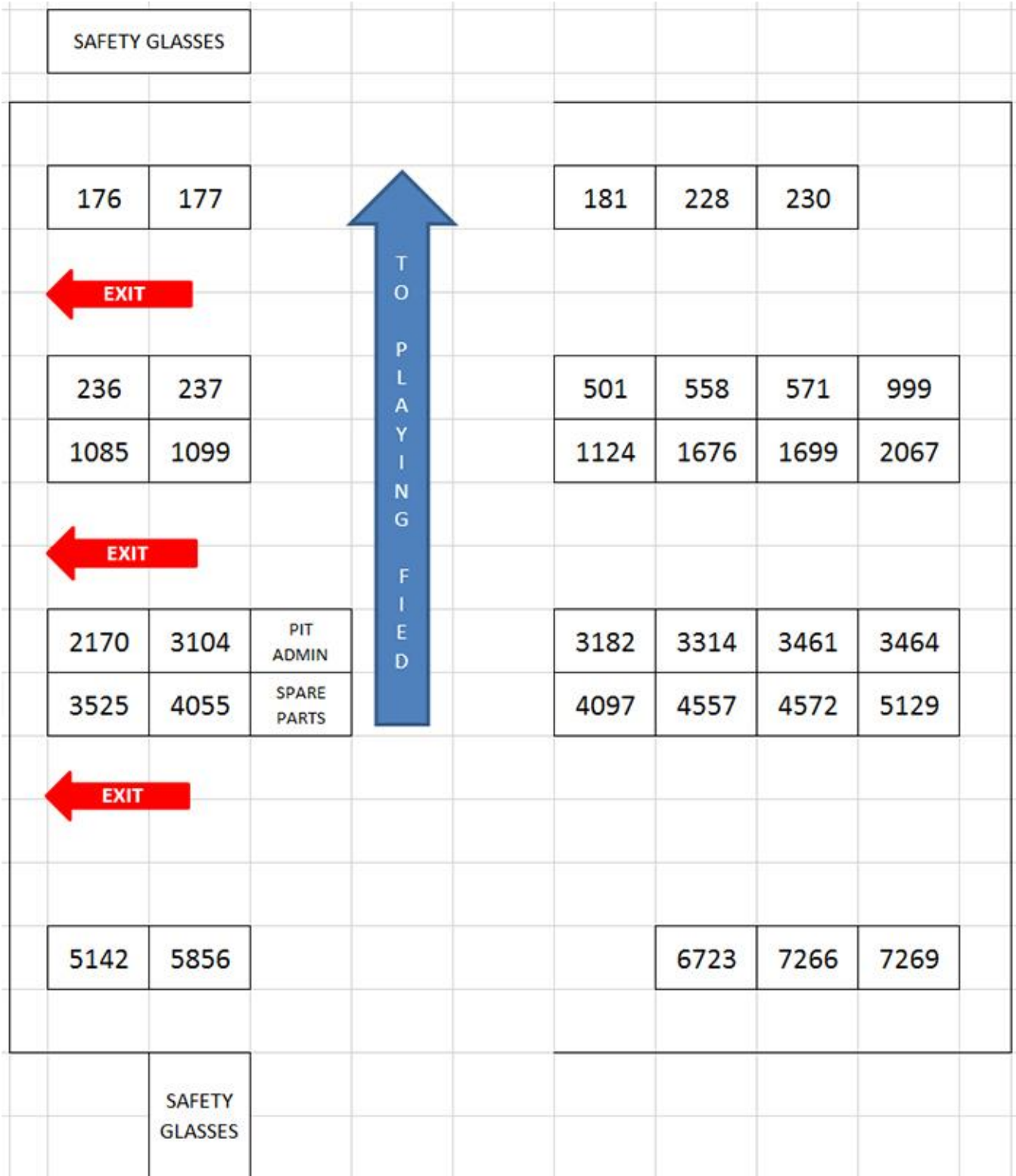

PLEASE SUPPORT THE CITY OF WATERBURY
BY DONATING
A CANNED OR NON-PERISHABLE FOOD ITEM
TO
OUR LOCAL FOOD BANK



**FEED THE
HUNGRY**

DONATIONS WILL BE ACCEPTED AT OUR EVENT.

THANK YOU TO OUR SPONSORS!

PRESENTING SPONSOR

United Technologies Corporation

REGIONAL SPONSORS

Analog Devices, Inc.

AT&T

BAE Systems

Bangor Savings Bank

IDEXX Laboratories, Inc.

Texas Instruments Inc.

Worcester Polytechnic Institute

EVENT SPONSORS

General Dynamics Electric Boat

Pfizer Inc.

The Peter and Carmen Lucia Buck Foundation



FIRST® Robotics Competition Game

FIRST® POWER UP™, the 2018 FIRST® Robotics Competition game, finds our teams trapped in an 8bit video game! Teams use power cubes to defeat the boss.

Each three-team alliance has three ways to help defeat the boss:

1. **Owning the scale or their switch.**
Ownership occurs when the scale or alliance's switch is tipped in their favor. Robots collect and deliver power cubes to gain ownership.
2. **Playing power ups.** Alliances exchange power cubes for power ups. Power ups provide a timed advantage during the match. There are three power ups that can be played: Force, Boost, and Levitate.
3. **Climbing the scale tower.** Robots work together to climb the scale tower to face the boss.

Autonomous Period:

- Robots operate independently following preprogrammed instructions for the first fifteen seconds of the match.
- Alliances score points by:
- Reaching their own autonomous line
 - Gaining ownership of the scale or their switch

Teleoperated Period:

- Operators take control for the final two minutes and fifteen seconds of the match.
- Alliances continue to score points by:
- Gaining ownership of the scale or their switch
 - Delivering power cubes to the alliance's vault
 - Using power ups for a timed advantage
 - Parking on the scale platform or climbing the scale to face the boss

The alliance with the highest score at the end of the match defeats the boss and wins.

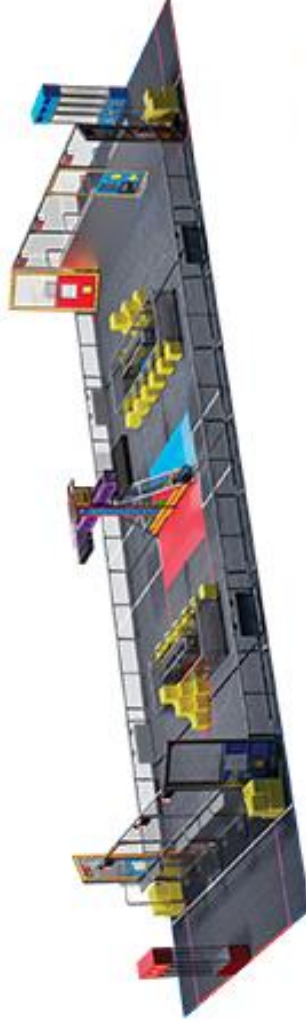

FIRST®, the FIRST logo, FIRST Robotics Competition, FIRST Tech Challenge, FIRST POWER UP™, Gamestorm™, and Gamestorm Pro™ are trademarks of For Inspiration and Recognition of Science and Technology (FIRST), LEGO®, and LEGO Technic™ are registered trademarks of the LEGO Group. FIRST LEGO League and FIRST LEGO League Jr. are joint/ held trademarks of FIRST and the LEGO Group. ©2017-2018 FIRST. All rights reserved. ®™



vent
cticut
2018